

TrailMaster TM31 (19/16) PARTS Manual

DIAGRAM	FRAME & ENGINE SYSTEM					
	No.	ERP Code	Part Description		QTY/Bike	Remark
	1	05.01.04.08025B	Bolt / M8*25		2	
	2	05.01.06.08025B	Bolt / M8*25		2	
	3	05.02.03.0103	Lock Nut / M8		8	
	4	03.05.0033	Rear Rack / K5		1	
	5	03.05.0087	Sub Frame		1	
	6	03.05.0086	Main Frame		1	
	7	05.02.03.0104	Lock Nut / M10		2	
	8	03.07.0001	Rear Hanging Brack, engine		1	
	9	06.02.0022	Engine /CB250D-G /ZONGSHEN		1	
	10	03.05.0022	Upper Hanging Bracket,engine / K5 1		2	
	11	06.02.0011	Start Lever		1	
	12	03.07.0039	Shift Lever		1	
	13	05.01.02.08060	Bolt M8*60		3	
	14	05.01.02.08095	Bolt M8*95		2	
	15	05.01.02.10115	Bolt M10*115		2	
	4	06.17.0009	Front Sprocket Cover		1	
	17	05.01.04.06025B	Bolt / M6*25		2	
	18	05.02.01.0101	Nut M6		2	
	19	05.01.02.06020	Bolt M6*20		1	
	20	05.01.02.06030	Bolt M6*30		2	
	21	03.05.0075	Water-proof Plug, rear rack		2	
	22	03.05.0034	Bracket, rear rack / K5		1	

DIAGRAM	Steering Handle Assy.					
	No.	ERP Code	Part Description		QTY/Bike	Remark
	1	06.31.0002	Start Switch		1	
	2	06.44.0006	Handle Bar 6061		1	
	3	06.31.0003	Kill Switch		1	
	4	03.01.0254	Handle Sleeve / RH		1	
	5	03.07.0080	Throttle Housing Assy. / X7-01		1	
	6	03.07.0193	Throttle Housing		1	
	7	05.01.04.06016B	Bolt / M6*16		2	
	8	03.07.0186	Handle Core		1	
	9	03.06.0236	Clutch Lever Assy. with Choke / K7-02 / AJ		1	
	10	06.08.0520	Bolt M6*20		2	
	11	06.08.0521	Mounts(Upper), clutch lever		1	
	12	06.08.0525	Spacer/ Ø24*Ø15*Ø8 / Black		1	
	13	06.08.0524	Bolt / M6*Ø8*42		1	
	14	06.08.0523	Choke Lever		1	
	15	06.08.0503	Clutch Lever		1	
	16	06.08.0519	Mounts(Bottom), Clutch lever		1	
	17	03.01.0253	Handle Grip / LH		1	

DIAGRAM	Steering Column Assy.					
	No.	ERP Code	Part Description		QTY/Bike	Remark
	1	03.05.0146	Triple Clamp(Bottom) 54 / K5		1	
	2	03.05.0023	Steering Column / K5-01		1	
	3	03.05.0145	Triple Clamp(Upper) 51 / K5		1	
	4	05.01.04.08040H	Bolt / M8*40		4	
	5	03.05.0148	Handle Bar Mounts(Bottom) / K5		2	
	6	03.05.0147	Handle Bar Mounts(Upper) / K5		2	
	7	05.01.04.08030B	Bolt / M8*30		4	
	8	05.04.01.0002	Tapered Roller Bearings (32005)		2	
	9	05.05.01.0106	Washer / Ø25*Ø37*1.5mm		1	
	10	05.01.04.06025B	Bolt / M6*25		4	
	11	03.05.0067	Lock Nut / K5-01		1	
	12	03.05.0068	Lock Nut / K5-01		1	
	13	03.05.0024	Dust Cover, steering column / Upper / K5-01		1	
	14	03.05.0025	Dust Cover, steering column / Bottom / K5-01		1	
	15	05.01.04.08025B	Bolt / M8*25		4	

DIAGRAM	Plastic Parts					
	No.	ERP Code	Part Description		QTY/Bike	Remark
	1	03.01.0006	Front Fender / NB-115/A7		1	
	2	03.05.0053	Bracket, front fender K5		1	
	3	03.05.0001	Front Upper Guard / LH / K5		1	
	4	03.05.0002	Front Upper Guard / RH / K5		1	
	5	03.05.0005	Front Middle Guard / LH / K5		1	
	6	03.05.0006	Front Middle Guard / RH / K5		1	
	7	03.05.0003	Front Bottom Guard / LH / K5		1	
	8	03.05.0004	Front Bottom Guard / RH / K5		1	
	9	03.05.0057	Bracket, front guard / K5		2	
	10	03.05.0010	Rear Guard with Air Filter Shell / RH/ K5		1	
	11	03.05.0009	Rear Guard Assy./L&RH/ K5		1	
	12	03.05.0008	Rear LH Guard / Bottom / K5		1	
	13	03.05.0007	Rear LH Guard / Top / K5		1	
	14	03.05.0012	Rear Water Fender / K5		1	
	15	03.05.0011	Rear Fender / K5		1	
	16	03.06.0108	Front Headlight / KMT-02		1	
	17	03.06.0376	Belt, headlight / KTM-02(K5)		2	
	18	03.05.0088	Seat Assy / K5		1	

19	05.05.01.0101	Washer			8	
20	05.01.11.0012D	Screw / ST4.2*13			20	
21	05.01.02.06012D	Bolt M6*12			6	
22	05.01.02.08025D	Bolt M8*25				
23	05.01.02.06016D	Bolt M6*16			6	
24	05.02.03.0102	Lock Nut / M6			2	
25	05.01.08.06035D	Bolt M6*35			1	

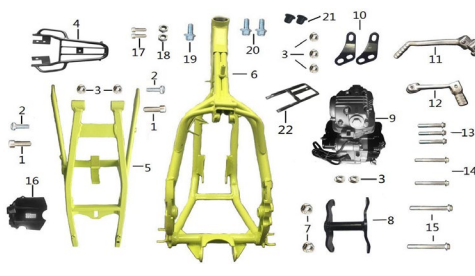
DIAGRAM	Air Filter & Carburetor Assy.					
	No.	ERP Code	Part Description		QTY/Bike	Remark
	1	03.05.0157	Sponge, air filter / K5		1	
	2	03.05.0041	Bracket, sponge of air filter / K5		1	
	3	03.05.0043	Plate, air filter hose / K5		1	
	4	03.05.0042	Strip, air filter / K5		1	
	5	03.05.0040	Intake soft pipe, air filter / K5		1	
	6	03.04.0082	Clamp, air filter		1	
	7	05.01.07.06016B	Screw M6*16		8	
	8	05.02.03.0102	Lock Nut M6		8	
	9	05.80.01.06055B	Butterfly-shap Bolt M6*55		1	
	10	06.27.0179	Carburetor PE28		1	
	11	03.01.0358	Clamp, intake pipe		1	
	12	03.05.0032	Intake Pipe, Carburetor		1	
	13	06.02.0028	Bakelite Gasket		1	
	14	06.07.0045	Seal Gasket, intake pipe		1	

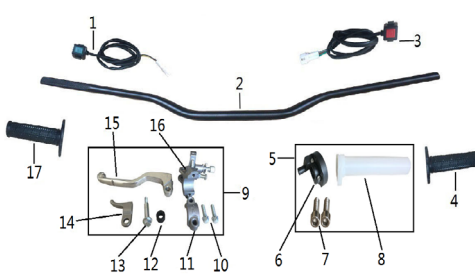
DIAGRAM	Oil Feeding System					
	No.	ERP Code	Part Description		QTY/Bike	Remark
	1	03.05.0175	Fuel Tank / K5-01		1	
	2	05.01.08.06035D	Bolt M6*35		1	
	3	03.04.0085	Front Positioning Spacer, seats / K3-01		1	
	4	03.05.0085	Fuel Cap / K5-01		1	
	5	06.54.0004	Fuel Filter- Model C		1	
	6	05.01.12.06010B	Screw / M6*10		2	
	7	05.01.06.06010B	Bolt / M6*10		4	
	8	06.54.0003	Outlet Oil Hose		3	
	9	06.45.0005	Vent Hose		1	
	10	03.01.0052	Clamp, oil pipe		6	

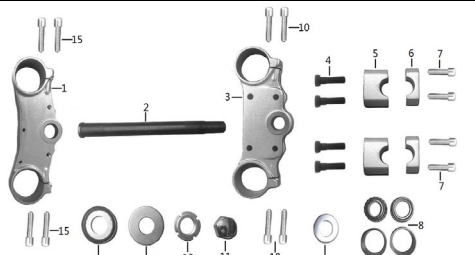
DIAGRAM	Wheel Assy.					
	No.	ERP Code	Part Description		QTY/Bike	Remark
	1	03.04.0063	Spacer No.6, front wheel / K5-01		2	
	2	03.05.0202	Front Wheel Assy. / K5-01		1	
	3	05.04.03.0010	Deep-groove Ball Bearings(6302)		2	
	4	03.05.0394	Front Wheel Assy. without bearings, oil seal & wheel hub spacer /1.6*19		1	
	5	06.42.0108	Oil Seal, front wheel		2	
	6	06.19.0020	Spacer, front wheel hub		1	
	7	06.42.0032	Front Inner Tube 70*100-19		1	
	8	06.42.0301	Front Tire 70*100-19		1	
	9	05.02.03.0110	Metal HEX Flange Retaining Nut / M6		10	
	10	06.08.0306	Front Brake Disc		1	
	11	05.01.01.06020B	HEX Bolt M6*20		10	
	12	05.02.07.0001	Nut M8		1	
	13	05.01.05.08033B	Screw M8*33		6	
	14	03.07.0117	Rear Sprocket 520-47T		1	
	15	05.02.03.0103	Lock Nut / M8		6	
	16	05.05.01.0108	Washer Ø8*Ø16*1.5		1	
	17	03.05.0203	Rear Wheel Assy. / K5-01		1	
	18	05.04.03.0017	Deep-groove Ball Bearings(6203)		3	
	19	03.05.0394	Rear Wheel Assy. without bearings, oil seal & wheel hub spacer /2.15*18		1	
	20	06.42.0109	Oil Seal, rear wheel 25*47*7		2	
	21	06.19.0021	Spacer, rear wheel hub		1	
	22	06.42.0333	Rear Inner Tube- 90/100-16		1	
	23	06.42.0330	Rear Tire -90/100-16		1	
	24	06.08.0308	Rear Brake Disc		1	
	25	06.42.0319	Cushion, inner tube lock		1	
	26	06.42.0315	Front Inner Tube Lock		1	
	27	06.42.0316	Rear Inner Tube Lock		1	
	28	03.05.0060	Spacer No.6, rear wheel / LH / K5-01		1	
	29	03.05.0061	Spacer No.6, rear wheel / RH / K5-01		1	

DIAGRAM	Footpegs & Stand Assy.					
	No.	ERP Code	Part Description		QTY/Bike	Remark
	1	03.06.0035	Foot pegs / LH / K7-01		1	
	2	03.06.0036	Foot pegs / RH / K7-01		1	
	3	03.06.0039	Returning Spring, footpegs / LH / K7-01		1	
	4	03.05.0104	Spring, footpegs / K5		1	



5	03.03.0030	Latch, footpegs / K1-01			2	
6	03.06.0034	Pin, footpegs / K7-01			2	
7	03.05.0181	Bracket, side stand / K5-01			1	
8	05.01.02.08025D	Bolt M8*25			2	
9	05.02.03.0103	Lock Nut / M8			2	
10	03.05.0180	Side Stand / K5			1	
11	05.80.08.10035D	Bolt / M10*35			1	
12	05.02.01.0103	HEX Nut M10*1.25			1	
13	03.06.0103	Spring, side stand / K7-01			1	

DIAGRAM

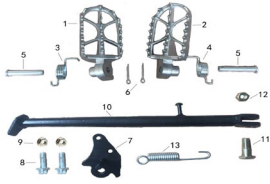

Rear Swingarm Assy.

No.	ERP Code	Part Description			QTY/Bike	Remark
1	03.01.0188	Spacer, swingarm / 18*28*6			2	
2	03.01.0189	Bushing, swingarm / 17*22*52			2	
3	03.01.0187	Oil Seal, swingarm / 28*37*6			2	
4	03.01.0186	Oil Seal, swingarm / 28*37*6			2	
5	05.04.04.0001	Stamped Roller Bearings / 22*30*16			4	
6	05.02.03.0107	Nut M16			2	
7	05.80.02.17240D	Axle, Swingarm / K5			1	
8	03.01.0102	Fixed Cap, chain slider / A7-01			3	
9	05.01.07.06012D	Screw / M8*12			5	
10	03.01.0101	Chain Slider / A7-01			1	
11	03.07.0027	Chain Guide / X7-01			1	
12	05.02.03.0102	Lock Nut / M6			2	
13	05.01.02.06030D	Bolt / M6*30			2	
14	05.01.02.17245D	Bolt / M16*Ø17*245			1	
15	03.05.0070	Chain Adjuster / K5-01			2	
16	05.05.01.0113	Washer Ø17*Ø30*3			1	
17	05.01.01.10045D	Bolt M10*45*1.25			2	
18	05.02.01.0103	Nut M10*1.25			2	
19	03.05.0098	Rear Swingarm Assy. / K5-02			1	
20	03.03.0012	Hose Holder, rear brake / K1-01			2	
21	03.06.0051	Swingarm Plug			2	
22	05.04.06.0002	Thrust Bearings / 32*22*6			2	

DIAGRAM



Linkage Assy.

No.	ERP Code	Part Description			QTY/Bike	Remark
1	03.05.0159	Oil Seal, linkage lever / Ø20*Ø28*4			2	
2	05.04.04.0006	Needle Roller Bearings / Ø20*Ø26*12			1	
3	03.05.0158	Linkage Lever			1	
4	03.05.0160	Oil Seal, linkage / Ø17*Ø24*5			6	
5	03.05.0078	Spacer, linkage connecting rod / Ø17*Ø12.5*77			1	
6	05.02.03.0104	Lock Nut / M10*1.25			2	
7	05.01.02.10085D	Bolt / M10*85*1.25			1	
8	05.01.02.10065D	Bolt / M10*65*1.25			1	
9	05.02.03.0103	Lock Nut / M8			1	
10	05.04.03.0006	Deep-groove Ball Bearings (608)			2	
11	03.01.0034	Chain Roller / Bottom / A7-01			1	
12	03.01.0230	Spacer, chain roller			1	
13	05.02.03.0105	Nut M12*1.25			1	
14	05.04.04.0007	Needle Roller Bearings / Ø17*Ø23*12			6	
15	03.05.0161	Linkage Arm / K5-01			1	
16	05.80.07.0001	Axle, Linkage Arm / K5-01			1	
17	06.35.0014	Chain 520-108L/SF			1	
18	03.05.0080	Spacer, linkage lever / K5-01/Ø17*Ø10.5*39.5			1	
19	03.05.0079	Spacer, linkage lever / K5-01/Ø17*Ø10.5*58			1	
20	03.05.0081	Spacer, linkage lever / K5-01/Ø20*Ø10.5*20.2			1	

DIAGRAM

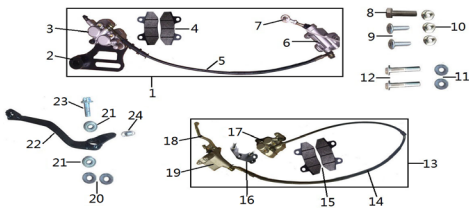

Brake Assy.

No.	ERP Code	Part Description			QTY/Bike	Remark
1	03.05.0016	Rear Brake Assy. / K5-01 / HK			1	
2	06.08.0536	Bracket, rear brake / HK			1	
3	06.08.0538	Rear Brake Caliper / HK			1	
4	06.08.0540	Rear Brake Disc / HK			2	
5	06.08.0539	Rear Brake Hose / HK			1	
6	06.08.0537	Rear Brake Master Cylinder / HK			1	
7	05.04.05.0001	Fish-eye Jointball			1	
8	05.01.01.06025B	HEX Bolt M6*25			1	
9	05.01.06.06025B	Bolt / M6*25			2	
10	05.02.03.0110	Lock Nut / M6			3	
11	05.05.01.0108	Washer Ø8			2	
12	05.01.02.08035D	Bolt M8*35			2	
13	03.05.0015	Front Brake Assy. / K5-01 / HK			1	
14	06.08.0532	Front Brake Hose / HK			1	
15	06.08.0535	Front Brake Disc / HK			2	
16	06.08.0559	Bracket, front brake / K5 / HK			1	
17	06.08.0534	Front Brake Caliper / HK			1	
18	06.08.0531	Brake Lever / HK			1	
19	06.08.0533	Front Brake Master Cylinder / HK			1	
20	05.05.02.0103	Washer Ø8			2	
21	05.04.03.0006	Deep-groove Ball Bearings (608)			2	
22	03.05.0162	Rear Brake Lever / K5-01			1	
23	GB/T 5789	HEX Flange Bolt M8*35			1	
24	03.05.0018	Returning Spring, rear brake / K5-01			1	

DIAGRAM	Exhaust Pipe Assy.						
	No.	ERP Code	Part Description			QTY/Bike	Remark
	1	03.01.0236	Seal Gasket C, exhaust pipe			1	
	2	03.05.0054	Exhaust Pipe(Front Part) / K5-01			1	
	3	05.02.03.0103	Metal HEX Flange Retaining Nut / M8			2	
	4	05.05.02.0103	Washer / Ø8*Ø18*1.5			2	
	5	05.01.06.08020D	HEX Socket Flat Bolt / M8*20			1	
	6	03.05.0055	Rear Silencer /Exhaust Pipe / K5-01			1	
	7	05.01.04.08020D	Bolt / M8*20			1	
	8	03.01.0100	Spring, exhaust pipe / A7-02			2	

DIAGRAM	Suspension Assy.						
	No.	ERP Code	Part Description			QTY/Bike	Remark
	1	03.05.0074	Front Fork / RH / KKE			1	
	2	03.05.0073	Front Fork / LH / KKE			1	
	3	03.05.0036	Front Fork Guard / RH / K5-01			1	
	4	03.05.0035	Front Fork Guard / LH / K5-01			1	
	5	03.05.0089	Hose Holder, front fork guard / K5-01			2	
	6	05.01.02.15235D	Bolt / Ø15*M14*235			1	
	7	05.02.03.0106	Lock Nut / M14			1	
	8	03.05.0094	Rear Suspension / K5-01 / KKE			1	
	9	05.01.13.10043D	T-shape Bolt M10*43*1.25			1	
	10	05.01.02.10060D	Bolt M10*80			1	
	11	05.02.03.0104	Lock Nut M10			2	
	12	05.02.03.0102	Lock Nut M6			2	
	13	05.01.12.06016B	Screw / M6*16			8	

DIAGRAM	Electronic Parts						
	No.	ERP Code	Part Description			QTY/Bike	Remark
	1	03.07.0061	Throttle Cable / ZMX7-250			1	
	2	03.07.0062	Clutch Cable / ZMX7-250			1	
	3	03.07.0063	Choke Cable / ZMX7-250			1	
	4	03.05.0122	Bracket, ignition switch / K5			1	
	5	06.13.0003	Ignition Switch			1	
	6	06.14.0007	Relay / CB			1	
	7	06.14.0008	Rectifier No.1 / CB			1	
	8	06.02.0007	CDI / CB-223			1	
	9	06.14.0009	Ignition Coil / CB			1	
	10	06.26.0003	Clip			6	
	11	03.01.0043	Battery Belt / A7-01			1	
	12	06.12.0212	Battery / 12V 5AH			1	
	13	03.05.0127	Main Wire Harness/ Air Cooling / K5			1	
	14	03.06.0108	Headlight Assy.			1	

DIAGRAM	Stickers						
	No.	ERP Code	Part Description			QTY/Bike	Remark
	1	03.05.0395	TrailMaster sticker/Red			1	
	2	03.05.0396	TrailMaster sticker/Orange			1	
	3	03.05.0397	TrailMaster sticker/Green			1	

TrailMaster TM33-CB250 (21/18) PARTS Manual

DIAGRAM	Engine Assy.				
	No.	ERP Code	Part Description	QTY/Bike	Remark
	1	06.02.0022	Engine / CB250D-G /Zongshen	1	
	2	06.02.0028	Intake Mainfold Mat /ZS223	1	
	3	03.01.0223	Intake Mainfold /xzJQ-4w	1	
	4	03.01.0358	Intake Mainfold Clamp	1	
	5	06.27.0158	Carburetor PE30	1	
	6	05.02.03.0104	Locknuts M10	2	
	7	05.01.02.1011 SD	Bolt M10*115	2	
	8	03.07.0001	Rear Engine Mount / K5, K7, X7	1	
	9	06.11.0007	Front Sprocket Cover	1	
	10	03.07.0039	Shift Lever /X7-01	1	
	11	06.02.0011	Kick Start Lever	1	
	12	06.27.0165	Carburetor Main Jet and Pilot jet Kit /PWK34/YL	1	
	13	05.02.01.0101	Bolt M8*90	2	
	14	05.02.03.0103	Locknuts M8	5	
	15	05.01.02.0805 SD	Bolt M8*50	2	
	16	05.01.02.0806 SD	Bolt M8*60	1	
	17	03.06.0291	Engine Mount(Upper) /LH /K7	1	
	18	03.06.0290	Engine Mount(Upper) /RH /K7	1	

DIAGRAM	Exhaust Pipe Assy.					
	No.	ERP Code	Part Description	QTY/Bike	Remark	
	1	03.04.0237	Spacer/Rear turn light / K3	1		
	2	03.01.0236	Seal Gasket C, Exhaust Pipe	1		
	3	03.06.0350	Exhaust Head Pipe / K7	1		
			03.06.0349	Exhaust Rear Silencer / K7	1	

DIAGRAM	Triple Clamps Assy.				
	No.	ERP Code	Part Description	QTY/Bike	Remark
	1	05.01.04.0803 nr	Screw M8*30	4	
	2	03.01.0328	Handle Bar Mounts(Upper) AF22	2	
	3	03.01.0329	Handle Bar Mounts(Lower) AF22	2	
	4	03.01.0242	Triple Clamps(Upper) AF37	1	
	5	05.01.02.1005 SD	Bolt M10*55*1.25	2	
	6	03.01.0126	Lock Nut / A7-01	1	
	7	03.01.0058	Dust Cover / Upper / A7-01	1	
	8	03.01.0227	Steering Column7075	1	
	9	05.01.02.0804 nr	Bolt M8*40	8	
	10	03.06.0119	Triple Clamps(Lower) AF37	1	
	11	03.01.0060	Dust Cap Seal / Lower / A7-01	1	
	12	05.04.01.0005	Tapered Roller Bearings (320/30)	2	
	13	03.01.0105	Buffer Conical Socket, Handle Bar / A7-03	4	
	14	03.01.0106	Inner Spacer, Handle Bar /A7-03	2	
	15	03.01.0124	Locknut / A7-04	1	

DIAGRAM	Frame				
	No.	ERP Code	Part Description	QTY/Bike	Remark
	1	03.06.0295	Main Frame / K7	1	
	2	03.06.0297	Sub Frame / K7	1	
	3	03.01.0019	Chain Roller / Upper / A7-01	1	
	4	03.06.0051	Plug, Swingarm	2	
	5	03.02.0035	Skid Plate / H7-01	1	

DIAGRAM	Foot Pegs Assy.				
	No.	ERP Code	Part Description	QTY/Bike	Remark
	1	03.06.0035	Foot Pegs / LH / K7-01	1	
		03.06.0036	Foot Pegs / RH / K7-01	1	
	2	03.05.0104	Foot Pegs Spring / K5	1	
	3	03.03.0030	Foot Pegs Mounting Pin Kit	2	
	4	05.06.01.0101	Foot Pegs Mounting Pin Kit	2	
	5	03.06.0131	Side Stand /K7	1	
	6	03.06.0103	Side Stand Spring /K7-01	1	
	7	03.02.0017	Rear Brake Return Spring / H7-01	1	
	8	03.06.0393	Rear Foot Brake Pedal Tip /K7	1	
	9	03.06.0394	Rear Foot Brake Lever / K7	1	
	10	05.04.03.0006	Deep-groove Ball Bearings (608)	2	
	11	03.06.0300	Rear Foot Brake Lever Spacer / K7	1	
	12	05.02.01.0103	Nut M10	1	
	13	05.08.08.1003 SD	Bolt M10*35	1	
14	03.06.0039	Foot Pegs Return Spring / LH / K7-01	1		

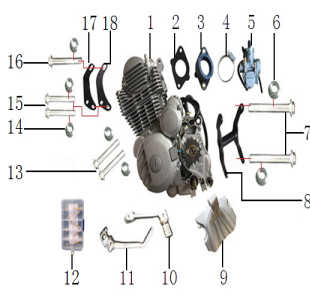
DIAGRAM	Linkage Assy.					
	No.	ERP Code	Part Description		QTY/Bike	
	1	05.80.07.0004	Linkage Axle / K7		1	
	2	05.04.04.0004	Needle Roller Bearings (NKF182614)		2	
	3	03.01.0103	Oil Seal, Linkage / 25*32*4		2	
	4	03.01.0067	End Cap, Linkage 25*5*12		2	
	5	03.05.0160	Linkage Oil Seal / 17*24*5		4	
	6	05.04.04.0007	Needle Roller Bearings (HK1712)		4	
	7	03.06.0317	Linkage Spacer / K7 / $\varnothing 12.2 \times \varnothing 17 \times 58\text{mm}$		1	
	8	05.01.02.1209	Bolt M12*95		1	
	9	05.01.02.1208	Bolt M12*83		1	
	10	03.06.0318	Linkage Spacer / K7 / $\varnothing 12.2 \times \varnothing 17 \times 38\text{mm}$		1	
	11	03.05.0081	Linkage Spacer / K5-01 / $\varnothing 20 \times \varnothing 10.5 \times 20.2$		1	
	12	05.04.04.0006	Needle Roller Bearings (HK2012)		1	
	13	03.05.0159	Linkage Oil Seal/20*26*4		2	
	14	03.01.0176	Bearing Bushing,Linkage / 12*18*77		1	
	15	05.02.03.0103	Locknuts M8		1	
	16	05.04.03.0006	Deep-groove Ball Bearings (608)		2	
	17	03.01.0034	Chain Roller / Lower / A7-01		1	
	18	03.01.0230	Chain Roller Spacer 8*12*11		1	
	19	05.02.03.0105	Nut M12		3	
	20	03.01.0140	Linkage Arm -1/A7-01		1	
	21	03.05.0158	Triangle Lever Linkage Arm/K5-01		1	

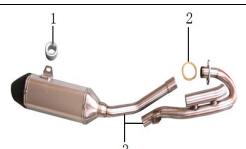
DIAGRAM	Swingarm Assy.					
	No.	ERP Code	Part Description		QTY/Bike	Remark
	1	03.07.0220	Rear Steel Swingarm / K7		1	
	2	03.01.0101	Chain Slider / A7-01		1	
	3	03.01.0102	Washer/ Chain Slider / A7-01		3	
	4	03.01.0142	Hose Holder, Rear Brake /A7-01		2	
	5	05.01.07.0501	Screw M5*12		9	
	6	03.01.0127	Chain Adjustor / LH / A7-01		1	
	7	03.01.0128	Chain Adjustor / RH / A7-01		1	
	8	03.01.0051	End Gasket, Swingarm / A7-01		2	
	9	05.02.01.0002	Nut M8		2	
	10	05.01.01.0805	Bolt M8*50		2	
	11	05.01.02.0601	Bolt M8*12		1	
	12	05.01.02.0604	Bolt M8*45		2	
	13	05.02.03.0102	Locknuts M6		2	
	14	03.01.0035	Chain Guide / A7-03		1	
	15	03.01.0037	Bracket / Chain Guide/ A7		1	
	16	03.06.0113	Swingarm Spacer 18*28*9		1	
	17	03.01.0187	Swingarm Oil Seal 28*37*6		2	
	18	05.04.06.0002	Thrust Bearings / H7-01 / 36*22*6		1	
	19	05.04.04.0001	Needle Roller Bearings (NK22/16)		4	
	20	03.01.0189	Swingarm Bushing 17*22*52MM /A7		2	
	21	03.01.0186	Swingarm Oil Seal 22*30*7/c 22*c 30*7		2	
	22	05.02.03.0107	Locknuts M16		1	
	24	05.01.02.1724	Bolt $\varnothing 17 \times 245$		1	

DIAGRAM	Suspension Assy.					
	No.	ERP Code	Part Description		QTY/Bike	Remark
	1	05.80.04.0601	Screw M6*10		6	
	2	03.05.0382	Front Fork Guards / LH		1	
	3	03.05.0384	Front Fork Guards / RH		1	
	4	05.01.13.1004	T-slots Bolt M10*43		1	
	5	05.02.03.0104	Locknuts M10		2	
	6	03.07.0243	Rear Suspension / 460MM /LC		1	
	7	05.01.02.1006	Bolt M10*60		1	
	8	02.09.0100	Front Fork Dust Cover / 41*54*13 / KKE		2	
	9	02.09.0107	Front Fork Oil Seal / 41*54*11 / KKE		2	
	10	03.05.0400	Front Fork / RH / 910MMLC		1	
	11	03.05.0401	Front Fork / LH / 910MMLC		1	

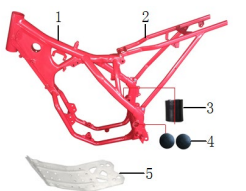
DIAGRAM	Handle Bar Assy.					
	No.	ERP Code	Part Description		QTY/Bike	Remark
	1	03.06.0559	Front Brake Assy. /K7/AJ/		1	
	1-1	06.08.0576	Front Brake Caliper / AJ		1	
	1-2	06.08.0577	Front Brake Pads / AJ		2	
	1-3	06.08.0575	Front Brake Hose / AJ		1	
	1-4	06.08.0578	Front Brake Master Cylinder / AJ		1	
	2	06.08.0563	Brake Lever / CNC		1	
	3	03.07.0227	Rear Brake Assy. / AJ		1	
	3-1	06.08.0591	Rear Brake Hose / AJ		1	
	3-2	06.08.0580	Rear Brake Caliper / AJ		1	
	3-3	06.08.0517	Rear Brake Bracket / AJ		1	
	3-4	06.08.0581	Rear Brake Pads / AJ		2	
	3-5	05.04.05.0001	Fish-eye Bearings		1	
	3-6	06.08.0507	Rear Brake Master Cylinder		1	
	4	03.01.0254	Handle Grips / RH		1	
	5	06.44.0017	Handle Bar/7075		1	
	6	03.07.0080	Throttle Housing Assy. / K7-01		1	
	7	06.31.0002	Start Switch		1	
	8	03.01.0016	Rear Brake Disc Guard / A7-01		1	
	9	03.01.0015	Rear Brake Caliper Guard / A7-01		1	
	10	03.06.0052	Clutch Lever Assy. with Choke /K7 / AJ		1	
	11	06.08.0415	Clutch Lever / CNC		1	
	12	05.02.03.0102	Locknuts M6		1	
	13	06.08.0540	Bolt, Clutch Lever M6*Ø8*30		1	
	14	06.31.0003	Kill Switch		1	
	15	03.01.0253	Handle Grips / LH		1	
	16	03.07.0062	Clutch Cable /ZMX7-250		1	
17	03.07.0061	Throttle Cable /ZMX7-250		1		
18	03.07.0063	Choke Cable /ZMX7-250		1		

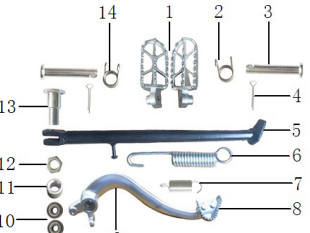
DIAGRAM		Front Wheel & Tire Assy.				
No.	ERP Code	Part Description			QTY/Bike	Remark
1	03.02.0162	Front Rim Assy./1.6"21			1	
1-1	06.36.0027	Aluminium Rim			1	
1-2	06.18.0103	Spoke Cap			36	
1-3	06.18.0001	Spoke			36	
1-4	06.19.0012	Front Wheel Hub			1	
2	06.42.0301	Front Tire 80"100-21			1	
3	06.42.0309	Front Inner Tube 80"100-21			1	
4	06.42.0319	Rim Lock Damper			1	
5	06.42.0315	Front Rim Lock			1	
6	05.05.01.0108	Washer			1	
7	05.02.07.0001	Nut M8			1	
8	06.19.0027	Front Wheel Hub Spacer $\varnothing 20X \varnothing 25X71$			1	
9	05.02.03.0107	Locknuts M16			1	
10	05.80.11.001	Front Wheel Axle			1	
11	06.42.0110	Front Wheel Oil Seal $\varnothing 28 \varnothing 37 \times 7$			2	
12	05.04.03.0022	Deep-groove Ball Bearings (6904)			2	
13	05.01.01.0602	Bolt M6*20			6	
14	05.02.03.0110	Locknuts M6			6	
15	06.08.0306	Front Brake Rotor / AJ			1	
16	06.42.0020	Front Wheel Spacer No.12			1	

DIAGRAM		Rear Wheel & Tire Assy.				
No.	ERP Code	Part Description			QTY/Bike	Remark
1	03.02.0163	Rear Rim Assy./2.15"18			1	
1-1	06.36.0028	Aluminium Rim			1	
1-2	06.18.0104	Spoke Cap			32	
1-3	06.18.0009	Spoke			16	
1-4	06.18.0010	Spoke			16	
1-5	06.19.0013	Rear Wheel Hub			1	
2	06.42.0300	Rear Tire 100/90-18			1	
3	06.42.0310	Rear Inner Tube 100/90-18			1	
4	06.35.0008	Chain 520H-118L/SF			1	
5	05.05.01.0108	Washer $\varnothing 8 \varnothing 16 \times 1.5$			1	
6	05.02.07.0001	Nut M8			1	
7	06.19.0028	Rear Wheel Hub $\varnothing 25X \varnothing 30X100$			1	
8	06.42.0316	Rear Rim Lock			1	
9	06.42.0105	Rear Wheel Oil Seal 32*47*7			2	
10	05.04.03.0024	Deep-groove Ball Bearings (6905)			3	
11	03.07.0147	Rear Sprocket 520-47T			1	
12	05.02.03.0110	Locknuts M8			6	
13	05.01.05.0803	Screw M8*33			6	
14	06.08.0308	Rear Brake Rotor / AJ			1	
15	05.01.01.0602	Bolt M6*20			4	
16	05.02.03.0111	Locknuts M22			1	
17	05.80.12.001	Rear Wheel Axle /A7			1	
18	06.42.0005	Rear Wheel Spacer No.4 / LH			1	
19	06.42.0006	Rear Wheel Spacer No.4 / RH			1	

DIAGRAM		Air Filter Assy.				
No.	ERP Code	Part Description			QTY/Bike	Remark
1	03.06.0047	Air Intake Hose, Air Filter / K7-02			1	
2	03.06.0080	Air Filter Clamp			1	
3	03.06.0050	Air Foam /K7			1	
4	03.06.0045	Clip Plate / K7			1	
5	03.06.0380	Fixed Tube, Air Foam / K7			1	
6	05.09.0001	E-clips $\varnothing 5.7 \varnothing 12 \times 1$			1	
7	03.06.0087	Rubber Mat /K7-01			1	
8	03.06.0285	Binder Plate Mounting, Air Filter / K7			1	
9	05.05.01.0109	Washer $\varnothing 8 \varnothing 17 \times 1.5$			1	
10	03.06.0046	Steel Wire, Air Foam / K7			1	
11						
12						

DIAGRAM		Electronic Parts				
No.	ERP Code	Part Description			QTY/Bike	Remark
1	06.02.0016	CDI/CB-249			1	
2	06.14.0009	Ignition Coil/CB			1	
3	06.13.0003	Ignition Switch			1	
4	03.06.0136	Main Wire Harness / K7			1	
5	03.02.0030	Relay Bracket / H7-01			1	
6	03.01.0043	Battery Strap / A7-01			1	
7	06.12.0211	Battery / 12V 6.5AH			1	
8	03.06.0288	Battery Box / K7			1	
9	03.06.0310	Ignition Switch Bracket			1	
10	03.06.0303	Timer Bracket / K7			1	
11	06.14.0011	Timer			1	
12	06.14.0008	Rectifier			1	
13	06.14.0007	Relay / CB			1	

DIAGRAM		Plastic Kit				
No.	ERP Code	Part Description			QTY/Bike	Remark
1	03.06.0205	Front Number Plate KS. K7. A7			1	
2	03.06.0021	Front Fender / K7			1	
3	03.06.0216	Mud Flap / K7			1	
4	03.06.0105	Front Side Panel(Upper) / K7 / LH / White			1	
	03.06.0004	Front Side Panel(Upper) / K7 / RH / White			1	
5	03.06.0105	Front Side Panel(Upper) / K7 / LH / White			1	
	03.06.0004	Front Side Panel(Upper) / K7 / RH / White			1	
6	03.06.0007	Mid Side Panel(Upper) / K7 / LH / White			1	



7	03.06.0008	Mid Side Panel(Upper) / K7 / RH / White			1	
7	03.06.0009	Air Box Covers/ K7			1	
8	03.06.0099	Rear Fender / K7			1	
9	03.06.0011	Mid Side Panel(Lower) / K7 / LH / White			1	
9	03.06.0010	Mid Side Panel(Lower) / K7 / RH / White			1	
10	03.06.0069	Radiator Guard / LH /K7			1	
11	03.06.0070	Radiator Guard / RH /K7			1	
12	03.06.0067	Radiator Guard Bracket / LH /K7			1	
13	03.06.0068	Radiator Guard Bracket / RH /K7			1	
14	03.01.0123	Radiator Guard Bracket Rubber Mat 10*21MM			2	
15	03.07.0035	T3 Headlight Bushing / X7-01			2	
16	03.06.0022	Headlight Assy. /K7			1	
16	03.06.0002	Headlight Mask /K7			1	
17	03.06.0025	Headlight Bracket / LH / K7			1	
18	03.06.0026	Headlight Bracket / RH / K7			1	
19	03.06.0054	Front Fender Bracket / K7			1	

DIAGRAM

Fuel Tank Assy.



No.	ERP Code	Part Description	QTY/Bike	Remark
1	03.05.0085	Fuel Tank Cap / K5-01	1	
2	05.80.04.0601 (D)	Screw M6*10	1	
3	06.45.0006	Vent Hose	1	
4	06.54.0004	Fuel Filter - Model C	1	
5	03.06.0086	Fuel Tank Rubber Mount(Front) / K7	1	
6	03.06.0284	Bolt / K7	1	
7	05.02.07.0031	Nut M12*1.25/S17	1	
8	03.06.0092	Fuel Tank / K7/Black	1	
9	03.06.0552	Seat /K7	1	

DIAGRAM

Stickers



No.	ERP Code	Part Description	QTY/Bike	Remark
1	03.06.0553	Stickers/TM33/Red	1 set	
2	03.06.0554	Stickers/TM33/Orange	1 set	
3	03.06.0555	Stickers/TM33/Green	1 set	
4	06.57.0010	Bar Pad	1	
5	06.57.0020	Bar Pad Cover	1	

TrailMaster TM36-CBS300(21/18) PARTS Manual

DIAGRAM	Engine Assy.					
	No.	ERP Code	Part Description		QTY/Bike	Remark
	1	06.11.0006	Engine /CBS300 / Zongshen		1	
	2	06.11.0008	Intake Mainfold		1	
	3	06.05.0006	Carburetor Clamp / NC250CC		1	
	4	06.27.0210	Carburetor PWK34		1	
	5	03.06.0331	Rear Engine Mount		1	
	6	05.01.02.10115D	Bolt M10*15		2	
	7	05.02.03.0104	Locknuts M10		2	
	8	06.11.0007	Front Sprocket Cover		1	
	9	06.27.0126	Carburetor Main Jet and Pilot Jet Kit /PWK34/YL		1	
	10	05.01.02.08050D	Bolt M8*50		2	
	11	05.01.02.08060D	Bolt M8*60		1	
	12	05.02.01.0101	Bolt M8*90		2	
	13	05.02.03.0103	Locknuts M8		5	
	14	03.06.0239	Rear Engine Mount /CBS300		2	
	15	03.06.0242	Rear Engine Mount Spacer / Upper / K7-CBS300		2	

DIAGRAM	Exhaust Pipe Assy.					
	No.	ERP Code	Part Description		QTY/Bike	Remark
	1	03.04.0237	Spacer/Rear turn light / K3		1	
	2	03.01.0236	Seal Gasket C, Exhaust Pipe		1	
	3	03.06.0359	Exhaust Head Pipe / K7/CBS300		1	
		03.06.0356	Exhaust Rear Silencer / K7		1	

DIAGRAM	Triple Clamps Assy.					
	No.	ERP Code	Part Description		QTY/Bike	Remark
	1	05.01.04.08030B	Screw M8*30		4	
	2	03.01.0328	Handle Bar Mounts(Upper) AF22		2	
	3	03.01.0329	Handle Bar Mounts(Lower) AF22		2	
	4	03.01.0242	Triple Clamps(Upper) AF37		1	
	5	05.01.02.10055B	Bolt M10*55*1.25		2	
	6	03.01.0126	Lock Nut / A7-01		1	
	7	03.01.0058	Dust Cover / Upper / A7-01		1	
	8	03.01.0227	Steering Column7075		1	
	9	05.01.02.08040D	Bolt M8*40		8	
	10	03.01.0243	Triple Clamps(Lower) AF37		1	
	11	03.01.0060	Dust Cap Seal / Lower / A7-01		1	
	12	05.04.01.0005	Tapered Roller Beatings (320/30)		2	
	13	03.01.0105	Buffer Conical Socket, Handle Bar / A7-03		4	
	14	03.01.0106	Inner Spacer, Handle Bar /A7-03		2	
	15	03.01.0124	Lock Nut / A7-04		1	

DIAGRAM	Frame					
	No.	ERP Code	Part Description		QTY/Bike	Remark
	1	03.06.0360	Main Frame / K7		1	
	2	03.06.0297	Sub Frame / K7		1	
	3	03.01.0019	Chain Roller / Upper / A7-01		1	
	4	03.06.0051	Plug, Swingarm		2	
	5	03.02.0035	Skid Plate / H7-01		1	

DIAGRAM	Foot Pegs Assy.					
	No.	ERP Code	Part Description		QTY/Bike	Remark
	1	03.06.0035	Foot Pegs / LH / K7-01		1	

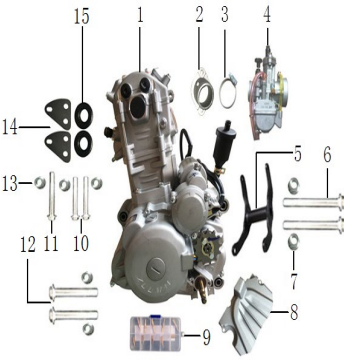

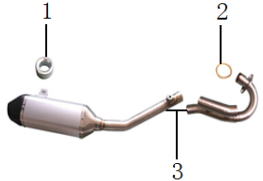
03.06.0036	Foot Pegs / RH / K7-01			1	
2	03.05.0104	Foot Pegs Spring / K5		1	
3	03.03.0030	Foot Pegs Mounting Pin Kit		2	
4	05.06.01.0101			2	
5	03.06.0131	Side Stand /K7		1	
6	03.06.0103	Side Stand Spring / K7-01		1	
7	03.02.0017	Rear Brake Return Spring / H7-01		1	
8	03.06.0393	Rear Foot Brake Pedal Tip /K7		1	
9	03.06.0394	Rear Foot Brake Lever / K7/CJ		1	
10	05.04.03.0006	Deep-groove Ball Bearings (608)		2	
11	03.06.0300	Rear Foot Brake Lever Spacer / K7		1	
12	05.02.01.0103	Nut M10		1	
13	05.80.08.10035D	Bolt M10*35		1	
14	03.06.0039	Foot Pegs Return Spring / LH / K7-01		1	

DIAGRAM

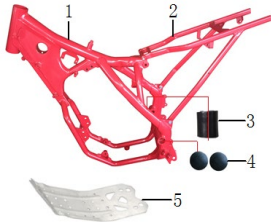
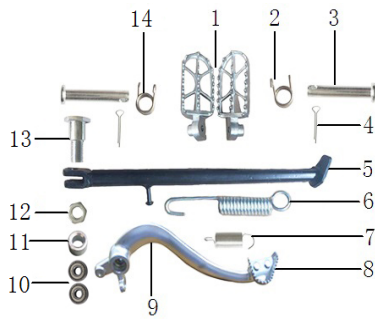
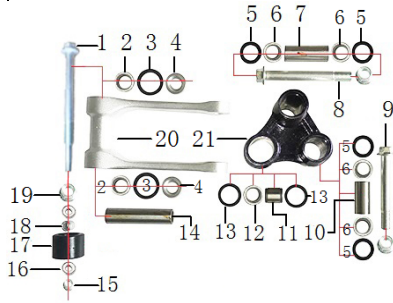

Linkage Assy.					
No.	ERP Code	Part Description		QTY/Bike	Remark
1	05.80.07.0004	Linkage Axle / K7		1	
2	05.04.04.0004	Needle Roller Bearings (NKF182614)		2	
3	03.01.0103	Oil Seal, Linkage / 25*32*4		2	
4	03.01.0067	End Cap, Linkage 25*5*12		2	
5	03.05.0160	Linkage Oil Seal / 17*24*5		4	
6	05.04.04.0007	Needle Roller Bearings (HK1712)		4	
7	03.06.0317	Linkage Spacer / K7 / c 12.2x c 17x58mm		1	
8	05.01.02.12095D	Bolt M12*95		1	
9	05.01.02.12083D	Bolt M12*83		1	
10	03.06.0318	Linkage Spacer / K7 / c 12.2x c 17x38mm		1	
11	03.05.0081	Linkage Spacer / K5-01 / c 20x c 10.5x20.2		1	
12	05.04.04.0006	Needle Roller Bearings (HK2012)		1	
13	03.05.0159	Linkage Oil Seal/20*26*4		2	
14	03.01.0176	Bearing Bushing,Linkage / 12*18*77		1	
15	05.02.03.0103	Locknuts M8		1	
16	05.04.03.0006	Deep-groove Ball Bearings (608)		2	
17	03.01.0034	Chain Roller / Lower / A7-01		1	
18	03.01.0230	Chain Roller Spacer 8*12*11		1	
19	05.02.03.0105	Nut M12		3	
20	03.01.0140	Linkage Arm -1/A7-01		1	
21	03.05.0158	Triangle Lever Linkage Arm/K5-01		1	

DIAGRAM

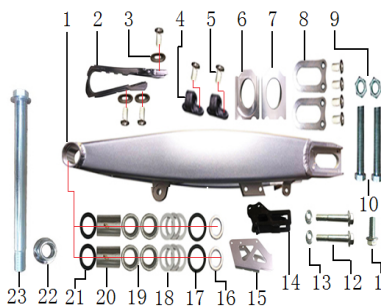

Swingarm Assy.					
No.	ERP Code	Part Description		QTY/Bike	Remark
1	03.06.0139	Rear Swingarm / K7		1	
2	03.01.0101	Chain Slider / A7-01		1	
3	03.01.0102	Washer/ Chain Slider / A7-01		3	
4	03.01.0142	Hose Holder, Rear Brake /A7-01		2	
5	05.01.07.05012D	Screw M5*12		9	
6	03.01.0127	Chain Adjustor / LH / A7-01		1	
7	03.01.0128	Chain Adjustor / RH / A7-01		1	
8	03.01.0051	End Gasket, Swingarm / A7-01		2	
9	05.02.01.0002	Hexagon Nut M8		2	
10	05.01.01.08050C	Bolt M8*50		2	
11	05.01.02.06012D	Bolt M6*12		1	
12	05.01.02.06045D	Bolt M6*45		2	
13	05.02.03.0102	Locknuts M6		2	
14	03.01.0035	Chain Guide / A7-03		1	
15	03.01.0037	Bracket / Chain Guide/ A7		1	
16	03.06.0113	Swingarm Spacer 18*28*9		1	
17	03.01.0187	Swingarm Oil Seal 28*37*6		2	
18	05.04.06.0002	Thrust Bearings / H7-01 / 36*22*6		1	
19	05.04.04.0001	Needle Roller Bearings (NK22/16)		4	
20	03.01.0189	Swingarm Bushing 17*22*52MM /A7		2	
21	03.01.0186	Swingarm Oil Seal 22*30*7/ c 22* c 30*7		2	
22	05.02.03.0107	Locknuts M16		1	
23	05.01.02.17245D	Bolt c 17*245		1	

DIAGRAM

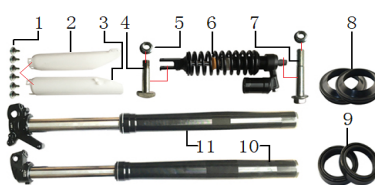

Suspension Assy.					
No.	ERP Code	Part Description		QTY/Bike	Remark
1	05.80.04.06010D	Screw M6*10		6	
2	03.01.0070	Front Fork Guards / LH / A7-03		1	
3	03.01.0071	Front Fork Guards / RH / A7-03		1	
4	05.01.13.10043D	T-slots Bolt M10*43		1	
5	05.02.03.0104	Locknuts M10		2	
6	03.01.0169	Rear Suspension / 480MM /KKE		1	
7	05.01.02.10060D	Bolt M10*60		1	
8	02.09.0100	Front Fork Dust Cover / 41*54*13 / KKE		2	
9	02.09.0107	Front Fork Oil Seal / 41*54*11 / KKE		2	
10	03.01.0312	Front Fork / RH / 910MM/KKE		1	
11	03.01.0311	Front Fork / LH / 910MM/KKE		1	

DIAGRAM

Handle Bar Assy.					
------------------	--	--	--	--	--

DIAGRAM

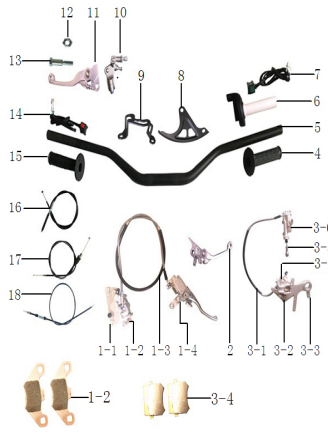

No.	ERP Code	Part Description	QTY/Bike	Remark
1	03.02.0268	Front Brake Assy./IH7. K7. A7/AJ/	1	
1-1	06.08.0576	Front Brake Caliper / AJ	1	
1-2	06.08.0577	Front Brake Pads / AJ	2	
1-3	06.08.0575	Front Brake Hose / AJ	1	
1-4	06.08.0578	Front Brake Master Cylinder / AJ	1	
2	06.08.0563	Brake Lever / CNC	1	
3	03.06.0381	Rear Brake Assy. / AJ	1	
3-1	06.08.0591	Rear Brake Hose / AJ	1	
3-2	06.08.0580	Rear Brake Caliper / AJ	1	
3-3	06.08.0517	Rear Brake Bracket / AJ	1	
3-4	06.08.0581	Rear Brake Pads / AJ	2	
3-5	05.04.05.0001	Fish-eye Bearings	1	
3-6	06.08.0507	Rear Brake Master Cylinder	1	
4	03.01.0254	Handle Grips / RH	1	
5	06.44.0017	Handle Bar/7075	1	
6	03.06.0091	Throttle Housing Assy. / K7-01	1	
7	06.31.0002	Start Switch	1	
8	03.01.0016	Rear Brake Disc Guard / A7-01	1	
9	03.01.0015	Rear Brake Caliper Guard / A7-01	1	
10	03.06.0043	Clutch Lever Assy. with Choke /K7 / AJ	1	
11	06.08.0415	Clutch Lever / CNC	1	
12	05.02.03.0102	Locknuts M6	1	
13	06.08.0540	Bolt, Clutch Lever M6*Ø8*30	1	
14	06.31.0003	Kill Switch	1	
15	03.01.0253	Handle Grips / LH	1	
16	03.06.0327	Clutch Cable /ZMX7-250	1	
17	03.07.0061	Throttle Cable /ZMX7-250	1	
18	03.07.0063	Choke Cable /ZMX7-250	1	

DIAGRAM

Front Wheel & Tire Assy.



No.	ERP Code	Part Description	QTY/Bike	Remark
1	03.02.0162	Front Rim Assy./1.6*21	1	
1-1	06.36.0027	Aluminium Rim	1	
1-2	06.18.0103	Spoke Cap	36	
1-3	06.18.0001	Spoke	36	
1-4	06.19.0012	Front Wheel Hub	1	
2	06.42.0301	Front Tire 80/100-21	1	
3	06.42.0309	Front Inner Tube 80*100-21	1	
4	06.42.0319	Rim Lock Damper	1	
5	06.42.0315	Front Rim Lock	1	
6	05.05.01.0108	Washer	1	
7	05.02.07.0001	Nut M8	1	
8	06.19.0027	Front Wheel Hub Spacer \varnothing 20X \varnothing 25X71	1	
9	05.02.03.0107	Locknuts M16	1	
10	05.80.11.001	Front Wheel Axle	1	
11	06.42.0110	Front Wheel Oil Seal \varnothing 26* \varnothing 37*7	2	
12	05.04.03.0022	Deep-groove Ball Bearings (6904)	2	
13	05.01.01.06020B	Bolt M6*20	6	
14	05.02.03.0110	Locknuts M6	6	
15	06.08.0306	Front Brake Rotor / AJ	1	
16	06.42.0020	Front Wheel Spacer No.12	1	

DIAGRAM

Rear Wheel & Tire Assy.



No.	ERP Code	Part Description	QTY/Bike	Remark
1	03.02.0163	Rear Rim Assy. / 2.15*18	1	
1-1	06.36.0028	Aluminium Rim	1	
1-2	06.18.0104	Spoke Cap	32	
1-3	06.18.0009	Spoke	16	
1-4	06.18.0010	Spoke	16	
1-5	06.19.0013	Rear Wheel Hub	1	
2	06.42.0300	Rear Tire 100/90-18	1	
3	06.42.0310	Rear Inner Tube 100/90-18	1	
4	06.35.0009	Chain 520H-118L/SF	1	
5	05.05.01.0108	Washer \varnothing 8* \varnothing 16*1.5	1	
6	05.02.07.0001	Nut M8	1	
7	06.19.0028	Rear Wheel Hub \varnothing 25X \varnothing 30X100	1	
8	06.42.0316	Rear Rim Lock	1	
9	06.42.0105	Rear Wheel Oil Seal 32*47*7	2	
10	05.04.03.0024	Deep-groove Ball Bearings (6905)	3	
11	03.07.0147	Rear Sprocket 520-47T	1	
12	05.02.03.0110	Hexagon Flange Locknuts M8	6	
13	05.01.05.08033B	Socket Flat Countersunk Head Cap Screw M8*33	6	
14	06.08.0308	Rear Brake Rotor / AJ	1	

15	05.01.01.06020B	Bolt M6*20			4		
16	05.02.03.0111	Locknuts M22			1		
17	05.80.12.001	Rear Wheel Axle /A7			1		
18	06.42.0005	Rear Wheel Spacer No.4 / LH			1		
19	06.42.0006	Rear Wheel Spacer No.4 / RH			1		

DIAGRAM		Air Filter Assy.						
No.	ERP Code	Part Description			QTY/Bike		Remark	
		1	03.06.0315	Air Intake Hose, Air Filter / K7-01		1		
		2	03.01.0219	Air Filter Clamp		1		
		3	03.06.0050	Air Foam /K7		1		
		4	03.06.0045	Clip Plate/ K7		1		
		5	03.06.0380	Fixed Tube, Air Foam / K7		1		
		6	05.09.0001	E-clips ϕ 5.7* ϕ 12*1		1		
		7	03.06.0087	Rubber Mat /K7-01		1		
		8	03.06.0285	Binder Plate Mounting, Air Filter / K7		1		
		9	05.05.01.0109	Washer ϕ 8* ϕ 17*1.5		1		
		10	03.06.0046	Steel Wire, Air Foam / K7		1		

DIAGRAM		Electronic Parts						
No.	ERP Code	Part Description			QTY/Bike		Remark	
		1	06.11.0003	CDI/CBS300		1		
		2	06.14.0009	Ignition Coil/CB		1		
		3	06.13.0007	Ignition Switch		1		
		4	03.06.0375	Main Wire Harness / K7/CBS300		1		
		5	03.02.0030	Relay Bracket / H7-01		1		
		6	03.01.0043	Battery Strap / A7-01		1		
		7	06.12.0211	Battery / 12V 6.5AH		1		
		8	03.06.0288	Battery Box / K7		1		
		9	03.06.0310	Ignition Switch Bracket		1		
		10	03.06.0303	Timer Bracket / K7		1		
		11	06.14.0011	Timer		1		
		12	06.11.0004	Rectifier		1		
		13	06.14.0007	Relay / CB		1		
		14	03.06.0253	Rectifier Bracket / K7-CBS300		1		

DIAGRAM		Plastic Kit						
No.	ERP Code	Part Description			QTY/Bike		Remark	
		1	03.06.0205	Front Number Plate /K5, K7, A7		1		
		2	03.06.0001	Front Fender / K7		1		
		3	03.06.0216	Mud Flap / K7		1		
		4	03.06.0105	Front Side Panel(Upper) / K7 / LH / white		1		
			03.06.0004	Front Side Panel(Upper) / K7 / RH /White		1		
		5	03.06.0105	Front Side Panel(Upper) / K7 / LH / White		1		
			03.06.0004	Front Side Panel(Upper) / K7 / RH / White		1		
		6	03.06.0007	Mid Side Panel(Upper) / K7 / LH / White		1		
			03.06.0008	Mid Side Panel(Upper) / K7 / RH / White		1		
		7	03.06.0009	Air Box Covers/ K7		1		
8	03.06.0099	Rear Fender / K7		1				
9	03.06.0011	Mid Side Panel(Lower) / K7 / LH / White		1				
	03.06.0010	Mid Side Panel(Lower) / K7 / RH / White		1				
10	03.06.0054	Front Fender Bracket / K7		1				

DIAGRAM		Fuel Tank Assy.						
No.	ERP Code	Part Description			QTY/Bike		Remark	
		1	03.05.0085	Fuel Tank Cap / K5-01		1		
		2	05.80.04.06010D	Screw M6*10		1		
		3	06.45.0006	Vent Hose		1		
		4	06.54.0004	Fuel Filter - Model C		1		
		5	03.06.0086	Fuel Tank Rubber Mount(Front) / K7		1		
		6	03.06.0284	Bolt / K7		1		
		7	05.02.07.0031	Nut M12*1.25/S17		1		
		8	03.06.0092	Fuel Tank / K7/Black		1		
		9	03.06.0552	Seat /K7		1		

DIAGRAM		Radiator					
No.	ERP Code	Part Description			QTY/Bike		Remark
1	03.01.0116	Radiator Guard / LH /A7			1		
2	03.01.0115	Radiator Guard / RH /A7			1		
3	03.06.0343	Radiator / LH /K7-01			1		
4	03.06.0344	Radiator / RH /K7-01			1		
5	03.06.0073	Fan / K7-01			1		

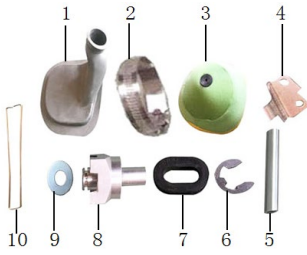

6	03.06.0074	Fan Temperature Switch / K7-01			1		
7	03.01.0065	Radiator Hose Clamp 16*25*8MM			10		
8	03.06.0204	Radiator Hose Tee			1		
9	03.06.0075	Radiator Hose Kit					
10	06.45.0016				1		
11	03.01.0119				1		
12	06.45.0017				1		
13	06.45.0015				1		
14	06.45.0014				1	\$1.37	

DIAGRAM



Stickers							
No.	ERP Code	Part Description			QTY/Bike		Remark
1	03.06.0553	Stickers/TM36/Red			1 set		
2	03.06.0554	Stickers/TM36/Orange			1 set		
3	03.06.0555	Stickers/TM36/Green			1 set		
4	06.57.0010	Bar Pad			1		
5	06.57.0020	Bar Pad Cover			1		

DIAGRAM



Lamps Assy.							
No.	ERP Code	Part Description			QTY/Bike		Remark
1	03.06.0025	Headlight Bracket /LH/K7			1		
2	03.06.0026	Headlight Bracket /RH/K7			1		
3	03.06.0022	Headlight Assy. /K7			1		
	03.06.0002	Headlight Mask / K7			1		
4	03.01.0123	Radiator Guard Bracket Rubber Mat 10*21MM /A7-04			2		
5	03.07.0035	T3 Headlight Bushing / X7-01			2		
6	06.13.0005	Ignition Switch			1		
7	03.02.0105	Speedmeter / LCD /H7-01			1		
8	03.02.0028	Ignition Switch Bracket /H7L			1		
9	03.06.0090	Speedmeter Bracket / K7-01			1		
10	03.06.0013	Tail Light Bracket / K7			1		
11	03.06.0023	Tail Light / K7			1		
12	03.06.0024	License Light / K7			1		
13	03.02.0137	Reflector /H7L			1		
14	03.02.0271	Turn Signals / RH			1		
15	03.02.0270	Turn Signals / LH					
16	03.06.0014	Liner Panel, Rear Fender / K7			1		

TrailMaster TM38-NC300 (21/18) PARTS Manual

DIAGRAM	Engine Assy.						
	No.	ERP Code	Parts Description			QTY/Bike	Remark
	1	06.04.0024	Engine NC298 / Zongshen			1	
	1-1	06.05.0004	Intake Mainfold			1	
	1-2	06.27.0178	Mainfold Boot			1	
	1-3	06.05.0006	Air Filter Clamp			2	
	1-4	05.01.02.0603 00D	Hexagon Flange Bolt M6*30			2	
	1-5	06.05.0001	Front Sprocket Cover			1	
	2	06.27.0210	Carburetor PWK34YL			1	
	3	03.01.0045	Shift Lever -2A/A7-01			1	
	4	05.03.01.0106	Spring Gasket			1	
	5	05.01.01.0602 00H	Bolt M6*20			1	
6	06.05.0002	Kick Start Lever			1		
7	06.27.0126	Carburetor Main Jet and Pilot jet Kit /PWK34/YL			1		
8	03.01.0057	Clutch Cable Bracket / A7-02			1		
9	03.07.0081	Rear Brake Tubing Clip			1		

DIAGRAM	Exhaust Pipe Assy.						
	No.	ERP Code	Parts Description			QTY/Bike	Remark
	1	03.04.0237	Spacer/Rear turn light / K3			1	
	2	03.01.0236	Seal Gasket C, Exhaust Pipe			1	
	3	03.06.0249	Exhaust Head Pipe / K7-NC			1	
		03.06.0356	Exhaust Rear Silencer / K7			1	

DIAGRAM	Triple Clamps Assy.						
	No.	ERP Code	Parts Description			QTY/Bike	Remark
	1	05.01.04.0803 00R	Screw M8*30			4	
	2	03.01.0328	Handle Bar Mounts(Upper) AF22			2	
	3	03.01.0329	Handle Bar Mounts(Lower) AF22			2	
	4	03.06.0357	Triple Clamps(Upper) AF37			1	
	5	05.01.02.1005 5R	Bolt M10*55*1.25			2	
	6	03.01.0126	Lock Nut / A7-01			1	
	7	03.01.0058	Dust Cover / Upper / A7-01			1	
	8	03.01.0227	Steering Column7075			1	
	9	05.01.02.0804 00D	Bolt M8*40			8	
	10	03.06.0358	Triple Clamps(Lower) AF37			1	
	11	03.01.0060	Dust Cap Seal / Lower / A7-01			1	
	12	05.04.01.0005	Tapered Roller Bearings (320/30)			2	
	13	03.01.0105	Buffer Conical Socket, Handle Bar / A7-03			4	
	14	03.01.0106	Inner Spacer, Handle Bar /A7-03			2	
	15	03.01.0124	Lock Nut / A7-04			1	

DIAGRAM	Frame						
	No.	ERP Code	Parts Description			QTY/Bike	Remark
	1	03.06.0138	Main Frame / K7			1	
	2	03.06.0297	Sub Frame / K7			1	
	3	03.01.0019	Chain Roller / Upper / A7-01			1	
	4	03.06.0051	Plug, Swingarm			2	
	5	03.02.0035	Skid Plate / H7-01			1	

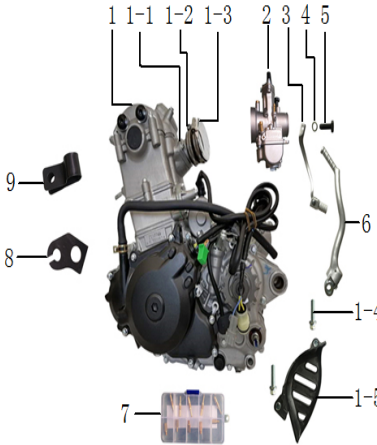

Foot Pegs Assy.									
No.	ERP Code	Parts Description						QTY/Bike	Remark
1	03.06.0035	Foot Pegs / LH / K7-01						1	
	03.06.0036	Foot Pegs / RH / K7-01						1	
2	03.05.0104	Foot Pegs Spring / K5						1	
3	03.03.0030	Foot Pegs Mounting Pin Kit						2	
4	05.06.01.0101							2	
5	03.06.0366	Side Stand /K7						1	
6	03.06.0103	Side Stand Spring / K7-01						1	
7	03.02.0017	Rear Brake Return Spring / H7-01						1	
8	03.06.0393	Rear Foot Brake Pedal Tip /K7						1	
9	03.06.0394	Rear Foot Brake Lever / K7/CJ						1	
10	05.04.03.0006	Deep-groove Ball Bearings (608)						2	
11	03.06.0300	Rear Foot Brake Lever Spacer / K7						1	
12	05.02.01.0103	Nut M10						1	
13	05.80.08.1003 5D	Bolt M10*35						1	
14	03.06.0039	Foot Pegs Return Spring / LH / K7-01						1	

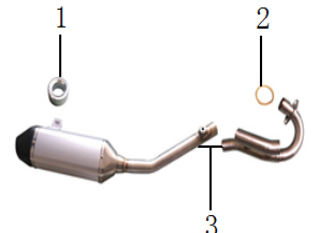

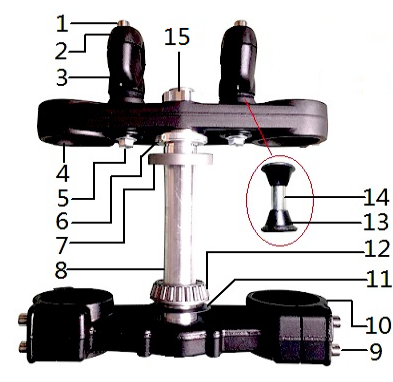
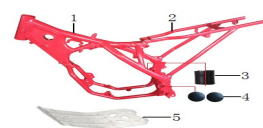
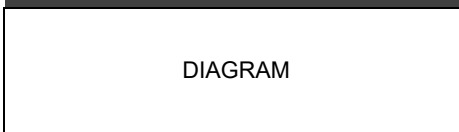
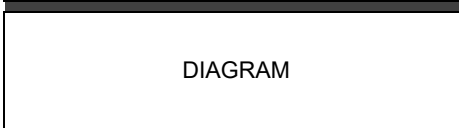
Linkage Assy.									
No.	ERP Code	Parts Description						QTY/Bike	Remark
1	05.80.07.0003	Linkage Axle / K7						1	
2	05.04.04.0004	Needle Roller Bearings (NKF182614)						2	
3	03.01.0103	Oil Seal, Linkage / 25*32*4						2	
4	03.01.0067	End Cap, Linkage 25*5*12						2	
5	03.05.0160	Linkage Oil Seal / 17*24*5						4	
6	05.04.04.0007	Needle Roller Bearings (HK1712)						4	
7	03.06.0317	Linkage Spacer / K7 / $\varnothing 12.2 \times \varnothing 17 \times 58\text{mm}$						1	
8	05.01.02.1209 5D	Bolt M12*95						1	
9	05.01.02.1208 3D	Bolt M12*83						1	
10	03.06.0318	Linkage Spacer / K7 / $\varnothing 12.2 \times \varnothing 17 \times 38\text{mm}$						1	
11	03.05.0081	Linkage Spacer / K5-01 / $\varnothing 20 \times \varnothing 10.5 \times 20.2$						1	
12	05.04.04.0006	Needle Roller Bearings (HK2012)						1	
13	03.05.0159	Linkage Oil Seal/20*26*4						2	
14	03.01.0176	Bearing Bushing,Linkage / 12*18*77						1	
15	05.02.03.0103	Locknuts M8						1	
16	05.04.03.0006	Deep-groove Ball Bearings (608)						2	
17	03.01.0034	Chain Roller / Lower / A7-01						1	
18	03.01.0230	Chain Roller Spacer 8*12*11						1	
19	05.02.03.0105	Nut M12						3	
20	03.01.0140	Linkage Arm -1/A7-01						1	
21	03.06.0506	Triangle Lever Linkage Arm/Aluminium						1	

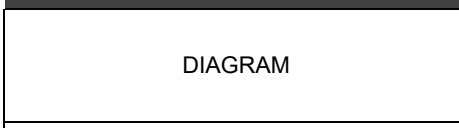

Swingarm Assy.									
No.	ERP Code	Parts Description						QTY/Bike	Remark
1	03.06.0032	Rear Aluminium Swingarm / K7						1	
2	03.01.0101	Chain Slider / A7-01						1	
3	03.01.0102	Chain Slider Bushing Dish Washer / H7-01						3	
4	03.01.0142	Hose Holder, Rear Brake /A7-01						2	
5	05.01.07.0501 2D	Cross Recess Sunk Screw M5*12						9	
6	03.01.0127	Chain Adjustor / LH / A7-01						1	
7	03.01.0128	Chain Adjustor / RH / A7-01						1	
8	03.01.0051	End Gasket, Swingarm / A7-01						2	
9	05.02.01.0002	Nut M8						2	
10	05.01.01.0805 0C	Bolt M8*50						2	
11	05.01.02.0601 0C	Bolt M6*12						1	
12	05.01.02.0604 5D	Bolt M6*45						2	
13	05.02.03.0102	Locknuts M6						2	
14	03.01.0035	Chain Guide / A7-03						1	
15	03.01.0037	Bracket / Chain Guide/ A7						1	
16	03.06.0113	Swingarm Spacer 18*28*9						1	
17	03.01.0187	Swingarm Oil Seal 28*37*6						2	
18	05.04.06.0002	Thrust Bearings / H7-01 / 36*22*6						1	
19	05.04.04.0001	Needle Roller Bearings (NK22/16)						4	

20	03.01.0189	Swingarm Bushing 17*22*52MM /A7			2		
21	03.01.0186	Swingarm Oil Seal 22*30*7/ø 22*ø 30*7			2		
22	05.02.03.0107	Locknuts M16			1		
23	05.01.02.1724 5D	Bolt ø 17*245			1		

DIAGRAM		Suspension Assy.					
No.	ERP Code	Parts Description			QTY/Bike	Remark	
1	05.80.04.0601 0D	Screw M6*10			6		
2	03.01.0068	Front Fork Guards / LH			1		
3	03.01.0069	Front Fork Guards / RH			1		
4	05.01.13.1004 3D	T-slots Bolt M10*43			1		
5	05.02.03.0104	Locknuts M10			2		
6	03.01.0169	Rear Suspension / 480MM /KKE			1		
7	05.01.02.1006 0D	Bolt M10*60			1		
8	02.09.0120	Front Fork Dust Cover / 48*58* (62) *13.5/KKE			2		
9	02.09.0121	Front Fork Oil Seal /48*57.8*9.5*12/KKE			2		
10	03.01.0312	Front Fork / RH / 910MM/KKE			1		
11	03.01.0311	Front Fork / LH / 910MM/KKE			1		

DIAGRAM		Handle Bar Assy.					
No.	ERP Code	Parts Description			QTY/Bike	Remark	
1	03.02.0171	Front Brake Assy. / AJ			1		
1-1	06.08.0556	Front Brake Caliper / AJ			1		
1-2	06.08.0398	Front Brake Pads / AJ			2		
1-3	06.08.0555	Front Brake Hose / AJ			1		
1-4	06.08.0504	Front Brake Master Cylinder / AJ			1		
2	06.08.0563	Brake Lever / CNC			1		
3	03.06.0282	Rear Brake Assy. / K7-01			1		
3-1	06.08.0510	Rear Brake Hose / AJ			1		
3-2	06.08.0508	Rear Brake Caliper / AJ			1		
3-3	06.08.0517	Rear Brake Bracket / AJ			1		
3-4	06.08.0410	Rear Brake Pads / AJ			2		
3-5	05.04.05.0001	Fish-eye Bearings			1		
3-6	06.08.0507	Rear Brake Master Cylinder			1		
4	03.01.0399	Handle Grips / RH			1		
5	06.44.0004	Handle Bar 7075			1		
6	03.06.0091	Throttle Housing Assy. / K7-01			1		
7	06.31.0002	Start Switch			1		
8	03.01.0016	Rear Brake Disc Guard / A7-01			1		
9	03.01.0015	Rear Brake Caliper Guard / A7-01			1		
10	03.06.0378	Clutch Lever Assy. without Choke /K7 / AJ			1		
11	06.08.0415	Clutch Lever / CNC			1		
12	05.02.03.0102	Locknuts M6			1		
13	06.08.0540	Bolt, Clutch Lever M6*Ø8*30			1		
14	06.31.0003	Kill Switch			1		
15	03.01.0398	Handle Grips / LH			1		
16	03.01.0182	Clutch Cable /YKZM-CLU			1		
17	03.07.0061	Throttle Cable /ZMX7-250			1		

DIAGRAM		Front Wheel & Tire Assy.					
No.	ERP Code	Parts Description			QTY/Bike	Remark	
1	03.02.0278	Front Rim Assy./1.6*21			1		
1-1	06.36.0027	Aluminium Rim			1		
1-2	06.18.0103	Spoke Cap			36		
1-3	06.18.0001	Spoke			36		
1-4	06.19.0045	Front Wheel Hub			1		
2	06.42.0301	Front Tire 80/100-21			1		
3	06.42.0309	Front Inner Tube 80*100-21			1		
4	06.42.0319	Rim Lock Damper			1		
5	06.42.0315	Front Rim Lock			1		
6	05.05.01.0108	Washer			1		



7	05.02.07.0001	Nut M8			1		
8	06.19.0027	Front Wheel Hub Spacer $\varnothing 20X \varnothing 25X71$			1		
9	05.02.03.0107	Locknuts M16			1		
10	05.80.11.001	Front Wheel Axle			1		
11	06.42.0110	Front Wheel Oil Seal $\varnothing 26^* \varnothing 37^*7$			2		
12	05.04.03.0022	Deep-groove Ball Bearings (6904)			2		
13	05.01.01.0602 0R	Bolt M6*20			6		
14	05.02.03.0110	Locknuts M6			6		
15	06.08.0307	Front Brake Rotor / AJ			1		
16	06.42.0020	Front Wheel Spacer No.12			1		

DIAGRAM

Rear Wheel & Tire Assy.



No.	ERP Code	Parts Description			QTY/Bike		Remark
1	03.02.0279	Rear Rim Assy. / 2.15*18			1		
1-1	06.36.0028	Aluminium Rim			1		
1-2	06.18.0104	Spoke Cap			32		
1-3	06.18.0009	Spoke			16		
1-4	06.18.0010	Spoke			16		
1-5	06.19.0046	Rear Wheel Hub			1		
2	06.42.0300	Rear Tire 100/90-18			1		
3	06.42.0310	Rear Inner Tube 100/90-18			1		
4	06.35.0026	Chain 520H-114L/SF			1		
5	05.05.01.0108	Washer $\varnothing 8^* \varnothing 16^*1.5$			1		
6	05.02.07.0001	Nut M8			1		
7	06.19.0028	Rear Wheel Hub $\varnothing 25X \varnothing 30X100$			1		
8	06.42.0316	Rear Rim Lock			1		
9	06.42.0105	Rear Wheel Oil Seal 32*47*7			2		
10	05.04.03.0024	Deep-groove Ball Bearings (6905)			3		
11	03.07.0116	Rear Sprocket 520-47T			1		
12	05.02.03.0110	Locknuts M8			6		
13	05.01.05.0803 3R	Screw M8*33			6		
14	06.08.0308	Rear Brake Rotor / AJ			1		
15	05.01.01.0602 0R	Bolt M6*20			4		
16	05.02.03.0111	Locknuts M22			1		
17	05.80.12.001	Rear Wheel Axle /A7			1		
18	06.42.0005	Rear Wheel Spacer No.4 / LH			1		
19	06.42.0006	Rear Wheel Spacer No.4 / RH			1		

DIAGRAM

Air Filter Assy.

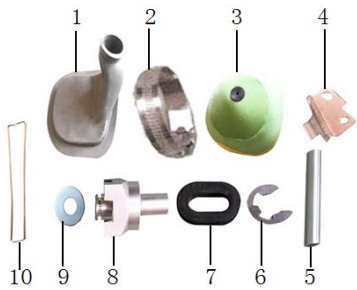

No.	ERP Code	Parts Description			QTY/Bike		Remark
1	03.06.0048	Air Intake Hose, Air Filter / K7-01			1		
2	03.01.0219	Air Filter Clamp			1		
3	03.06.0050	Air Foam /K7			1		
4	03.06.0045	Clip Plate/ K7			1		
5	03.06.0380	Fixed Tube, Air Foam / K7			1		
6	05.09.0001	E-clips $\varnothing 5.7^* \varnothing 12^*1$			1		
7	03.06.0087	Rubber Mat /K7-01			1		
8	03.06.0285	Binder Plate Mounting, Air Filter / K7			1		
9	05.05.01.0109	Washer $\varnothing 8^* \varnothing 17^*1.5$			1		
10	03.06.0046	Steel Wire, Air Foam / K7			1		

DIAGRAM

Electronic Parts



No.	ERP Code	Parts Description			QTY/Bike		Remark
1	06.11.0003	CDI/NC250			1		
2	06.14.0009	Ignition Coil/CB			1		
3	06.13.0007	Ignition Switch			1		
4	03.06.0065	Main Wire Harness / K7			1		
5	03.02.0030	Relay Bracket / H7-01			1		
6	03.01.0043	Battery Strap / A7-01			1		
7	06.12.0211	Battery / 12V 6.5AH			1		
8	03.06.0325	Battery Box / K7			1		
9	03.06.0310	Ignition Switch Bracket			1		
10	03.06.0303	Timer Bracket / K7			1		
11	06.14.0011	Timer			1		
12	06.11.0004	Rectifier /NC250			1		
13	06.14.0007	Relay / CB			1		

14	03.06.0253	Rectifier Bracket / K7-CBS300			1		
----	------------	-------------------------------	--	--	---	--	--

DIAGRAM		Plastic Kit					
No.	ERP Code	Parts Description			QTY/Bike	Remark	
1	03.06.0205	Front Number Plate /K5, K7, A7			1		
2	03.06.0001	Front Fender / K7			1		
3	03.06.0216	Mud Flap / K7			1		
4	03.06.0105	Front Side Panel(Upper) / K7 / LH / white			1		
	03.06.0004	Front Side Panel(Upper) / K7 / RH /White			1		
5	03.06.0105	Front Side Panel(Upper) / K7 / LH / White			1		
	03.06.0004	Front Side Panel(Upper) / K7 / RH / White			1		
6	03.06.0007	Mid Side Panel(Upper) / K7 / LH / White			1		
	03.06.0008	Mid Side Panel(Upper) / K7 / RH / White			1		
7	03.06.0009	Rear Side Panel / K7			1		
8	03.06.0099	Rear Fender / K7			1		
9	03.06.0011	Mid Side Panel(Lower) / K7 / LH / White			1		
	03.06.0010	Mid Side Panel(Lower) / K7 / RH / White			1		
10	03.06.0054	Front Fender Bracket / K7			1		

DIAGRAM		Fuel Tank Assy.					
No.	ERP Code	Parts Description			QTY/Bike	Remark	
1	03.05.0085	Fuel Tank Cap / K5-01			1		
2	05.80.04.0601 00	Screw M6*10			1		
3	06.45.0006	Vent Hose			1		
4	06.54.0004	Fuel Filter - Model C			1		
5	03.06.0086	Fuel Tank Rubber Mount(Front) / K7			1		
6	03.06.0284	Bolt / K7			1		
7	05.02.07.0031	Nut M12*1.25/S17			1		
8	03.06.0092	Fuel Tank / K7			1		
9	03.06.0410	Seat /K7			1		

DIAGRAM		Radiator					
No.	ERP Code	Parts Description			QTY/Bike	Remark	
1	03.01.0116	Radiator Guard / LH /A7			1		
2	03.01.0115	Radiator Guard / RH /A7			1		
3	03.06.0343	Radiator / LH /K7-01			1		
4	03.06.0344	Radiator / RH /K7-01			1		
5	03.06.0073	Fan / K7-01			1		
6	03.06.0074	Fan Temperature Switch / K7-01			1		
7	03.01.0065	Radiator Hose Clamp 16*25*8MM			10		
8	03.06.0204	Radiator Hose Tee			1		
9	03.06.0075	Radiator Hose Kit			1		
10	03.06.0077				1		
11	03.01.0119				1		
12	03.06.0076				1		
13	03.06.0079				1		
14	03.06.0078				1		

DIAGRAM		Stickers					
No.	ERP Code	Parts Description			QTY/Bike	Remark	
1	03.06.0553	Stickers/TM36/Red			1set		
2	03.06.0554	Stickers/TM36/Orange			1set		
3	03.06.0555	Stickers/TM36/Green			1set		
4	06.57.0010	Bar Pad			1		
5	06.57.0020	Bar Pad Cover			1		

DIAGRAM	Lamps Assy.						
	No.	ERP Code	Parts Description			QTY/Bike	Remark
	1	03.06.0025	Headlight Bracket /LH/K7			1	
	2	03.06.0026	Headlight Bracket /RH/K7			1	
	3	03.06.0022	Headlight Assy. /K7			1	
	3	03.06.0002	Headlight Mask / K7			1	
	4	03.01.0123	Radiator Guard Bracket Rubber Mat 10*21MM /A7-04			2	
	5	03.07.0035	T3 Headlight Bushing / X7-01			2	
	6	06.13.0005	Ignition Switch			1	
	7	03.02.0105	Speedmeter / LCD /H7-01			1	
	8	03.02.0028	Ignition Switch Bracket /H7L			1	
	9	03.06.0090	Speedmeter Bracket / K7-01			1	
	10	03.06.0013	Tail Light Bracket / K7			1	
	11	03.06.0023	Tail Light / K7			1	
	12	03.06.0024	License Ligh / K7			1	
	13	03.02.0137	Reflector /H7L			1	
	14	03.02.0271	Turn Signals / RH			1	
	15	03.02.0270	Turn Signals / LH				
16	03.06.0014	Liner Panel, Rear Fender / K7			1		